

BIMETALLIC JOINTS - STRAIGHT TYPE

MATERIAL : ELECTROLYTIC GRADE AL 99.5 AND COPPER

FINISH : BRIGHT

FEATURES : BARREL PREFILLED WITH OXIDE INHIBITING COMPOUND AND CAPPED

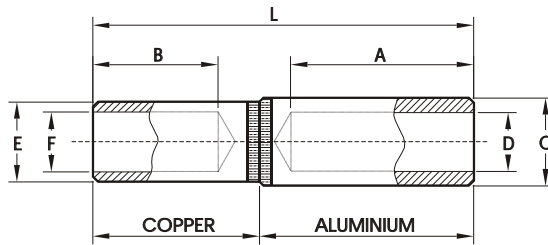

CABLE SIZE (AL)mm ²	CABLE SIZE (CU)mm ²	CAT. NO.	DIMENSIONS IN mm							PER BOX
			A	B	C	D	E	F	L	
25	25	SBMCS25	32	21.5	12	7	9.7	7	70	25
35	35	SBMCS35	32	21.5	12	8.5	11.5	8.4	70	20
50	50	SBMCS50	32	21.5	16	9.5	12.7	9.5	70	20
70	70	SBMCS70	32	21.5	16	11	14.3	11.1	70	20
95	95	SBMCS95	60	40	21.5	13	17.5	13.5	120	15
120	120	SBMCS120	60	40	21.5	15	20.6	15.5	120	15
150	150	SBMCS150	60	40	27	16.5	22.2	16.3	120	15
185	185	SBMCS185	60	40	27	18.5	24.3	18.3	120	15
240	240	SBMCS240	60	40	35	21	28.6	21.2	122	10
300	300	SBMCS300	60	40	35	23.5	31.9	23.8	125	10
400	400	SBMCS400	70	55	47	26.5	34.9	26.8	153	5
500	500	SBMCS500	70	58	47	29.5	38	30	155	5
630	630	SBMCS630	70	60	54	33.5	45	33.5	160	2

BIMETALLIC JOINTS - REDUCING TYPE

MATERIAL : ELECTROLYTIC GRADE AL 99.5 AND COPPER

FINISH : BRIGHT

FEATURES : BARREL PREFILLED WITH OXIDE INHIBITING COMPOUND AND CAPPED

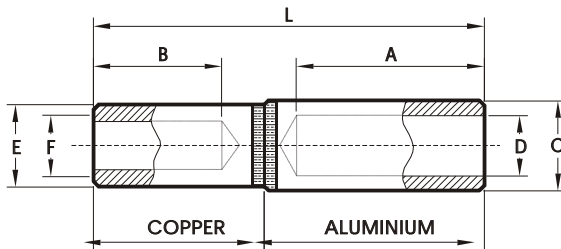

CABLE SIZE (AL)mm ²	CABLE SIZE (CU)mm ²	CAT. NO.	DIMENSIONS IN mm							PER BOX
			L	A	B	C	D	E	F	
35	25	SBMC3525	70	32	21.5	12	8.5	9.7	7	25
50	35	SBMC5035	70	32	21.5	16	9.5	11.5	8.4	20
70	50	SBMC7050	70	32	21.5	16	11	12.7	9.5	20
95	70	SBMC9570	70	60	40	21.5	13	14.3	11.1	15
120	70	SBMC1270	120	60	40	21.5	15	14.3	11.5	15
120	95	SBMC1295	120	60	40	21.5	15	17.5	13.5	15
150	120	SBMC1512	120	60	40	27	16.5	20.6	15.5	15
185	70	SBMC1870	120	60	40	27	18.5	14.3	11.5	15
185	150	SBMC1815	120	60	40	27	18.5	22.2	16.3	15
240	100	SBMC2410	122	60	40	35	21	17.5	13.5	10
240	185	SBMC2418	122	60	40	35	21	24.3	18.3	10
300	185	SBMC3018	125	60	40	35	23.5	24.3	18.5	10
300	240	SBMC3024	125	60	40	35	23.5	28.6	21.2	10
400	170	SBMC4017	153	70	55	47	28.5	24.3	18.3	5
400	300	SBMC4030	153	70	55	47	26.5	31.9	23.8	5
500	400	SBMC5040	155	70	58	47	29.5	34.9	26.8	5
630	500	SBMC6350	160	70	60	54	33.5	38	30	2

